

LEGEND

- MINOR WATERWAY
- MAJOR WATERWAY
- FENCE
- UNPAVED ROAD
- BRUSH LINE
- RAILROAD
- GROUND SURFACE ELEVATION CONTOUR
- SILT FENCE/HAYBALES

- SURVEY MONUMENT
- ROAD SIGN
- DECIDUOUS TREE
- FIRE HYDRANT
- MANHOLE GUIDE POST
- POLE
- UTILITY BOX
- COORDINATE GRID (250' GRID)
- OVERHEAD UTILITY POLE
- MAILBOX/RR SIGNAL
- MONITORING WELL LOCATION
MW17-5
- LIMITS OF 1-FOOT EXCAVATION
- LIMITS OF 2-FOOT EXCAVATION
- CONFIRMATORY FLOOR SOIL SAMPLE LOCATION
- PRE-EXCITATION CONFIRMATORY PERIMETER SOIL SAMPLE LOCATION
- POST-EXCITATION CONFIRMATORY PERIMETER SOIL SAMPLE LOCATION
- RI SURFACE SOIL LOCATION
SS17-40
- RI SEDIMENT SAMPLE LOCATION
SW/SD17-2

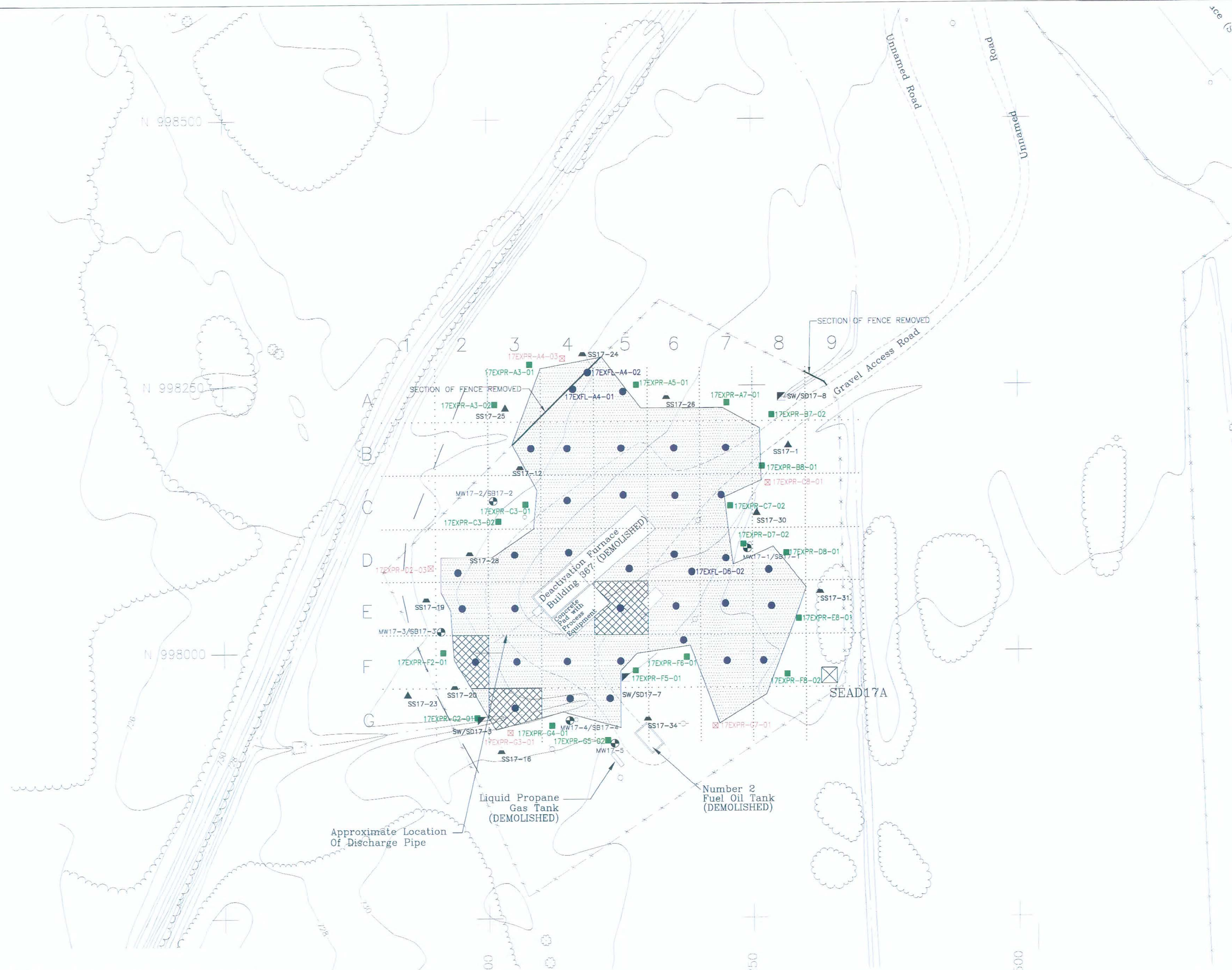

NOTES:

1. THE DATA ASSOCIATED WITH ALL OF THE CONFIRMATORY SOIL SAMPLE LOCATIONS SHOWN ON THIS DRAWING COMPRISE THE FINAL CONFIRMATORY SOIL DATASET. THE ANALYTICAL RESULTS FOR ALL THE SAMPLES COLLECTED AT THE FINAL SAMPLE LOCATIONS MEET THE SITE SPECIFIC CLEANUP GOALS.
2. FLOOR SAMPLES LOCATED IN THE CENTER OF A GRID WERE LABELED IN A CONSISTENT MANNER BASED ON THE GRID FROM WHICH THE SAMPLE WAS COLLECTED. THESE FLOOR SAMPLES WERE LABELED AS 17EXFL-ZZ-XX, WHERE THE "ZZ" REPRESENTS THE GRID NAME AND THE "XX" DENOTES THE SAMPLE NUMBER. FOR EXAMPLE, THE FLOOR SAMPLE COLLECTED AT GRID B5 WAS LABELED 17EXFL-B5-01. ALL FLOOR SAMPLES WERE COLLECTED AT A DEPTH RANGE OF 0-2 INCHES BGS. LABELS FOR ALL OTHER CONFIRMATORY SAMPLES ARE DISPLAYED ON THIS DRAWING.

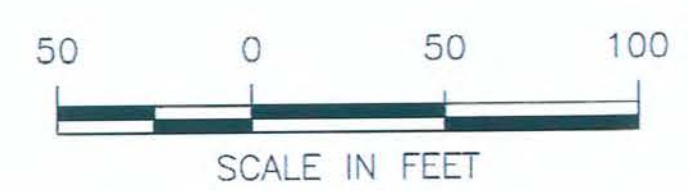

PARSONS

CLIENT/PROJECT TITLE
**SENECA ARMY DEPOT ACTIVITY
 CONSTRUCTION COMPLETION REPORT
 SEAD-16 AND SEAD-17**

DEPT. ENVIRONMENTAL ENGINEERING Dwg. No. 745172-01200

C-5
**SEAD-17 EXCAVATION AREA & FINAL
 CONFIRMATORY SAMPLE LOCATIONS**

SCALE 1" = 50'-0" DATE DECEMBER 2007 REV -

P:\PH\Projects\Seneca PBS\SEAD-16-17\Construction Completion Rpt\Drawt\Figures\C-5.dwg

01331-157