

DIVISION 17 - PLUMBING

SECTION 17010 - GENERAL PROVISIONS.

A. ALL WORK SHALL BE INSTALLED IN COMPLIANCE WITH APPLICABLE CODES AND NFPA 30.

B. PROVIDE SUBMITTALS OF OIL PIPING DIAGRAMS, TANKS, AND ALL REQUIRED EQUIPMENT PLUS OPERATING, MAINTENANCE, AND INSTRUCTION MANUALS AND PARTS LIST, AND CUTS AND/OR FABRICATION DWGS. OF REQUIRED ACCESSORIES.

C. PROVIDE ALL LABOR, MATERIALS, EQUIPMENT, AND SERVICES TO PERFORM ALL OPERATIONS REQUIRED FOR THE COMPLETE INSTALLATION AND RELATED WORK REQUIRED IN ALL CONTRACT DOCUMENTS.

SECTION 17060 - PIPE AND PIPE FITTINGS

A. STEEL PIPE AND FITTINGS

1. ASTM A-120 OR ASTM A-53 FOR EXTRA STRONG WEIGHT. BLACK STEEL FOR LIQUIDS, GALVANIZED FOR BOLLARDS.

2. SCREWED OR WELDED OR FLANGED FITTINGS AS REQUIRED.

3. COAT UNDERGROUND PIPING WITH THREE COATS BLACK ASPHALTUM.

SECTION 17080 - PIPING SPECIALTIES

A. HANGERS AND SLEEVES

1. HANGERS: WROUGHT IRON RISER ANCHOR AND RISER CLAMP.

2. SLEEVES: REQUIRED FOR ALL PIPING PASSING THROUGH FLOORS OR WALLS.

SECTION 17410 - EQUIPMENT

A. WASTE OIL AND WASTE SOLVENT TANKS

1. OWENS-CORNING FIBERGLASS TANKS FOR LIQUID CHEMICALS OR APPROVED EQUAL.

2. QUANTITY AND CAPACITIES AS NOTED ON PLAN.

3. EACH TANK EQUIPPED WITH THE FOLLOWING:

B. OIL AND SOLVENT PIPING ACCESSORIES

1. FILL BOX: OPW-DOVER CORPORATION #122 OR APPROVED EQUAL.

2. ADAPTOR: OPW-DOVER CORPORATION #51-AP OR APPROVED EQUAL.

3. ELBOW: OPW-DOVER CORPORATION #50 OR APPROVED EQUAL.

4. LOCK RING: OPW-DOVER CORPORATION #50-L OR APPROVED EQUAL.

5. EXTRACTION FITTING: OPW-DOVER CORPORATION #533-TEX OR APPROVED EQUAL.

6. VENT CAP: OPW-DOVER CORPORATION #25 OR APPROVED EQUAL.

7. SWING JOINTS: OPW-DOVER CORPORATION STYLE 30 DUCTILE IRON OR APPROVED EQUAL.

8. REMOTE READING, AUTOMATIC FLOAT TYPE GAUGE ASSEMBLY: LIQUIDMETER CORP. SENIOR MODEL, WATERPROOF, OR APPROVED EQUAL.

9. OVERSIZE FILL CUP ATTACHMENT: CONVEX DISHED HEAD, 3/16" HRS. 22" DIAMETER, 4" LIP, 8" OVERALL DEPTH WITH 10" LONG 3" SCHEDULE 40 PIPE OUTLET THREADED TO MATE WITH FILL BOX LISTED ABOVE AND CONTINUOUSLY WELDED TO DISHED HEAD.

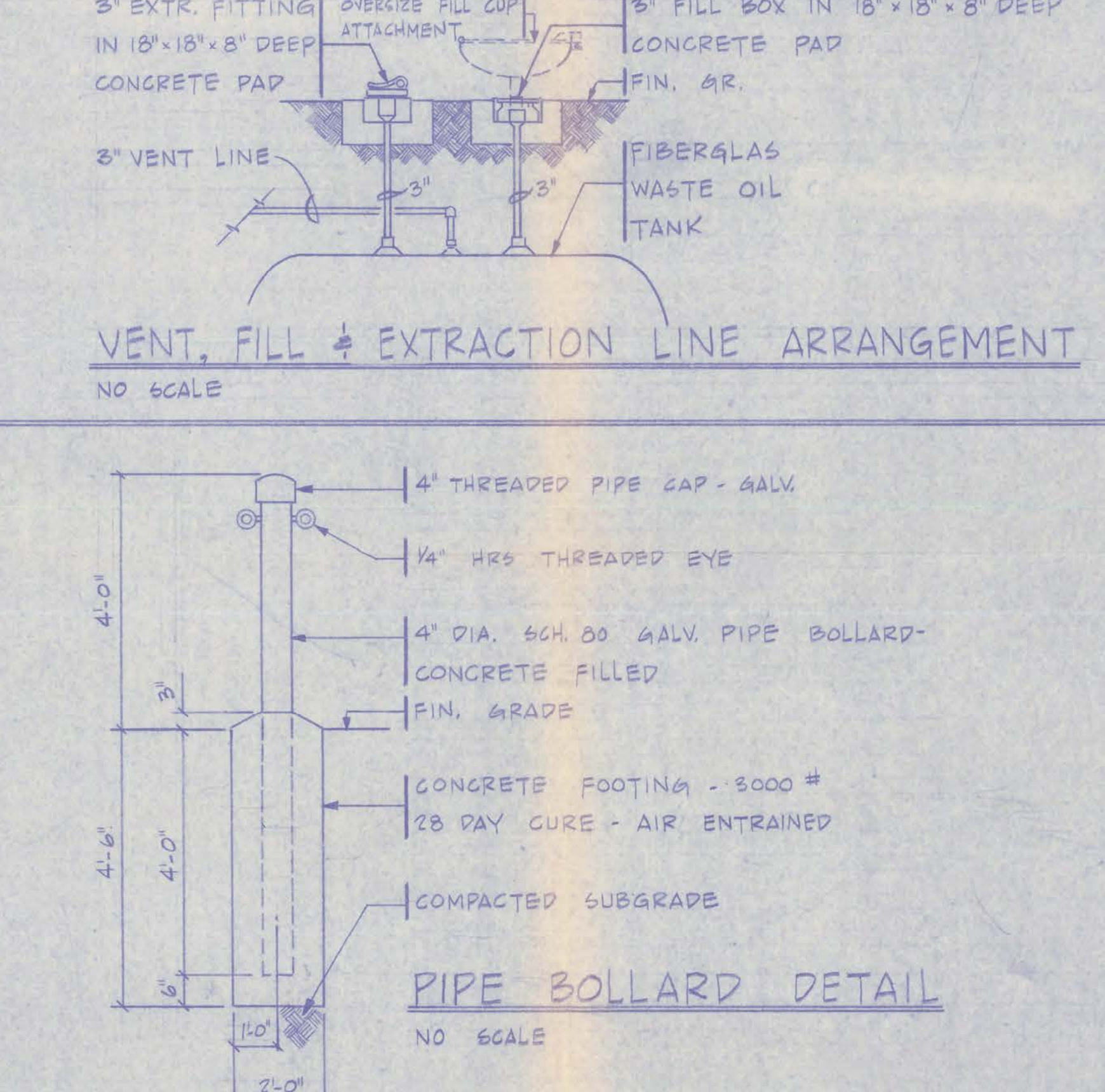
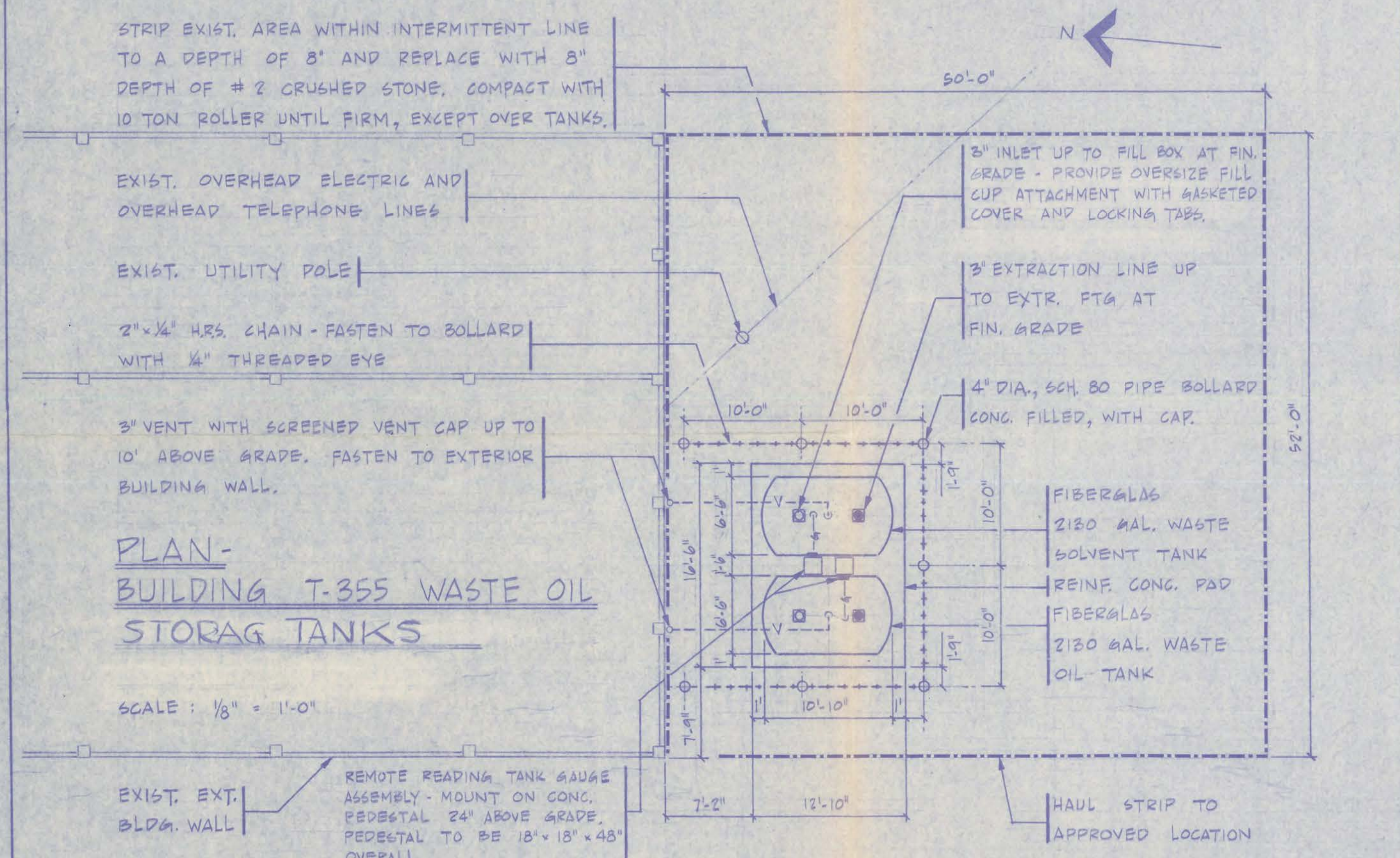
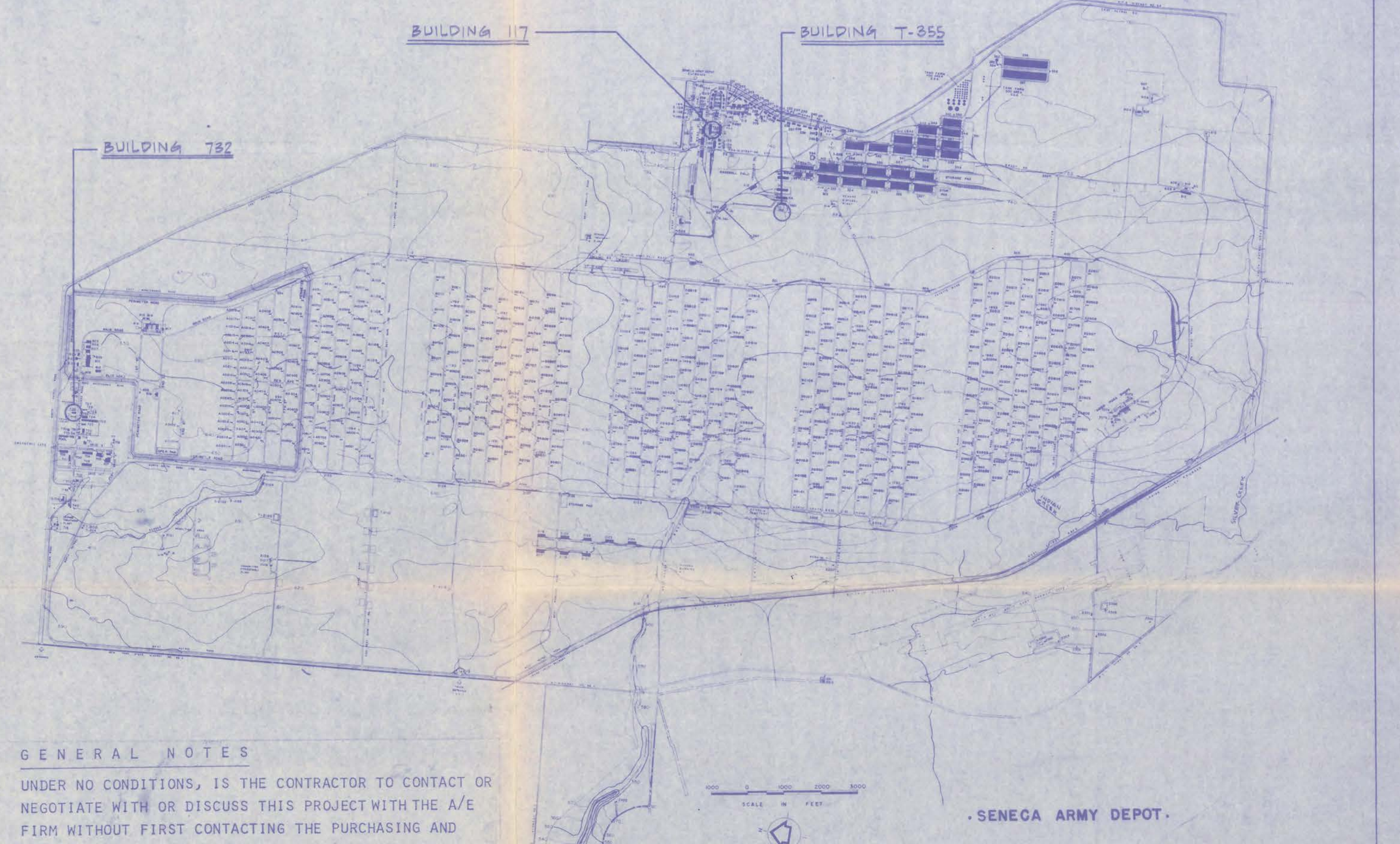

GENERAL NOTES

1. THE CONTRACTOR SHALL BE RESPONSIBLE TO IDENTIFY ALL EMPLOYEES, SUBCONTRACTORS, AND/OR SUPPLIERS WHO REQUIRE DEPOT ACCESS TO THE INTELLIGENCE OFFICE, SENECA ARMY DEPOT, AT LEAST 72 HOURS PRIOR TO THEIR INTENDED ARRIVAL ON POST.

2. THE CONTRACTOR SHALL BE RESPONSIBLE FOR BECOMING FAMILIAR WITH THE APPLICABLE SECURITY REGULATIONS AND IN INFORMING HIS EMPLOYEES AND THE EMPLOYEES OF SUBCONTRACTORS. ALL SECURITY REGULATIONS SHALL BE STRICTLY ENFORCED AND VIOLATION OF THE SAME SHALL BE CAUSE FOR DEBARMENT OF THE OFFENDER FROM THE POST.

3. IT SHALL BE THE CONTRACTORS RESPONSIBILITY TO SAFEGUARD ANY ACCESS MEDIA (BADGES, ETC.) ISSUED HIM OR HIS PERSONNEL. THE LOSS, MUTILATION OR MISUSE OF ANY DEPOT ACCESS MEDIA SHALL BE BROUGHT TO THE ATTENTION OF THE PROVOST MARSHAL SEAD, IMMEDIATELY.

4. THE CONTRACTOR SHALL BE RESPONSIBLE FOR THE SECURITY OF ANY EQUIPMENT, VEHICLES, SUPPLIES, AND/OR MATERIALS LEFT ON THE JOB SITE.

5. THE OPERATION OF ANY MOBILE/PORTABLE RADIO COMMUNICATIONS EQUIPMENT, INCLUDING CITIZEN BAND (CB) RADIOS IS PROHIBITED UNTIL THE CONTRACTOR HAS COORDINATED WITH THE COMMUNICATIONS, ELECTRONICS OFFICER (C-EO) (TEL. EXT. 18-436). THE ELECTROMAGNETIC RADIATION HAZARD (EMRH) CONTROL OFFICER (TEL. EXT. 18-277) AND AND THE PROVOST MARSHAL'S OFFICE (TEL. EXT. 18-265) AND RECEIVE APPROVAL TO OPERATE THE EQUIPMENT ON POST.

6. NO EXCAVATION OF MORE THAN 1 FOOT DEPTH SHALL BE UNDERTAKEN WITHOUT FIRST NOTIFYING THE CHIEF, MAINTENANCE DIVISION, USAAC - SENECA, (TEL. EXT. 7-299) AND ELECTRICIAN FOREMAN (TEL. EXT. 7-456) AND THE PLUMBING FOREMAN, (TEL. EXT. 7-470) FOR THE LOCATIONS AND IDENTIFICATION, AS NECESSARY, OF BURIED POWER, COMMUNICATIONS CABLES, WATER, STEAM AND SEWER LINES AT/OR IN THE VICINITY OF THE EXCAVATION OR JOB SITE.

7. THE CONTRACTOR IS RESPONSIBLE FOR PROVIDING ALL NECESSARY OCCUPATIONAL SAFETY EQUIPMENT FOR HIS AND THE SUBCONTRACTOR'S EMPLOYEES.

8. THE CONTRACTOR IS RESPONSIBLE FOR CONDUCTING ALL OPERATIONS IN ACCORDANCE WITH APPLICABLE FEDERAL, STATE AND LOCAL REGULATIONS. QUESTIONS CAN BE REFERRED TO THE SAFETY OFFICE, (TEL. EXT. 7-261 / 7-432).

9. ALL HAZARDOUS WORK, E.G. CUTTING AND WELDING, USE OF POWER ACTUATED TOOLS, REQUIRES A HAZARDOUS WORK / FLAME PERMIT ISSUED BY THE SAFETY OFFICE, (TEL. EXT. 7-261 / 7-432).

10. ALL OF THE CONTRACTOR'S EQUIPMENT SHALL BE EQUIPPED WITH AN APPROVED FIRE EXTING.

11. THE CONTRACTOR SHALL HAVE APPROVED TYPE SAFETY CANS, AND ONLY THESE SHALL BE USED FOR REFUELING OR STORAGE OF SMALL QUANTITIES OF FUEL.

12. ANY CONNECTIONS RESULTING IN SHUTDOWN OF THE FOLLOWING UTILITY SYSTEMS MUST BE SCHEDULED IN ADVANCE. (ELECTRICAL, WATER, SEWAGE, AND MAIN STEAM DISTRIBUTION SYSTEMS)

13. THE CONTRACTOR SHALL BE RESPONSIBLE FOR SAFEGUARDING & MAINTAINING SAFEGUARDS ON EXCAVATION.

14. PLUMBING WORK NOT COVERED UNDER PROJECT SPECIFICATIONS SHALL CONFORM TO AMERICAN SOCIETY OF MECHANICAL ENGINEERS (ASME) NATIONAL PLUMBING CODE. A40. (CURRENT).

15. ANY ELECTRICAL WORK NOT COVERED UNDER PROJECT SPECIFICATIONS SHALL CONFORM TO NATIONAL FIRE PROTECTION ASSOCIATION (NFPA) NATIONAL ELECTRICAL CODE. (CURRENT).

16. PRIOR TO EXCAVATION ACROSS ANY DEPOT ROADS THE CONTRACTOR SHALL ARRANGE FOR AND PROVIDE THE FOLLOWING: 1. NECESSARY DETOURS (COMPLETE WITH TEMPORARY ROADWAYS, PAVEMENTS, ETC.) 2. BARRICADES, FENCES AND TEMPORARY GUARD RAILS. 3. SIGNS, LIGHTS AND/OR OTHER NECESSARY SAFETY AIDS REQUIRED FOR SAFE TRAFFIC MOVEMENT. ALL SUCH DETOURS SHALL BE INSPECTED BY THE DEPOT SAFETY DEPARTMENT BEFORE USE OF DETOUR CAN BE ALLOWED FOR DEPOT TRAFFIC.

17. IT SHALL BE THE RESPONSIBILITY OF THE CONTRACTOR TO SURVEY & OTHERWISE POLICE ALL ROADS USED BY HIM WHEN DISPOSING OLD ROOFING, DEBRIS, NAILS, ETC. FROM THE WORK SITE TO DISPOSAL AREA.

18. THE CONTRACTOR SHALL NOT BE PERMITTED TO PLACE ANY CONCRETE, UNTIL THE CONTRACTING OFFICER'S REPRESENTATIVE HAS MADE A COMPLETE INSPECTION OF ALL WORK CONCERNING THE PREPARATION OF FORMS. A 24 HOUR NOTICE OF INTENT TO PLACE CONCRETE IS REQUIRED.

19. THIS DRAWING INDICATES THE EXTENT AND THE GENERAL LAYOUT OF THE WORK TO BE PERFORMED. ALL DIMENSIONS AND DATA SHOWN ON THE DRAWING SHALL BE VERIFIED IN THE FIELD BY THE CONTRACTOR.

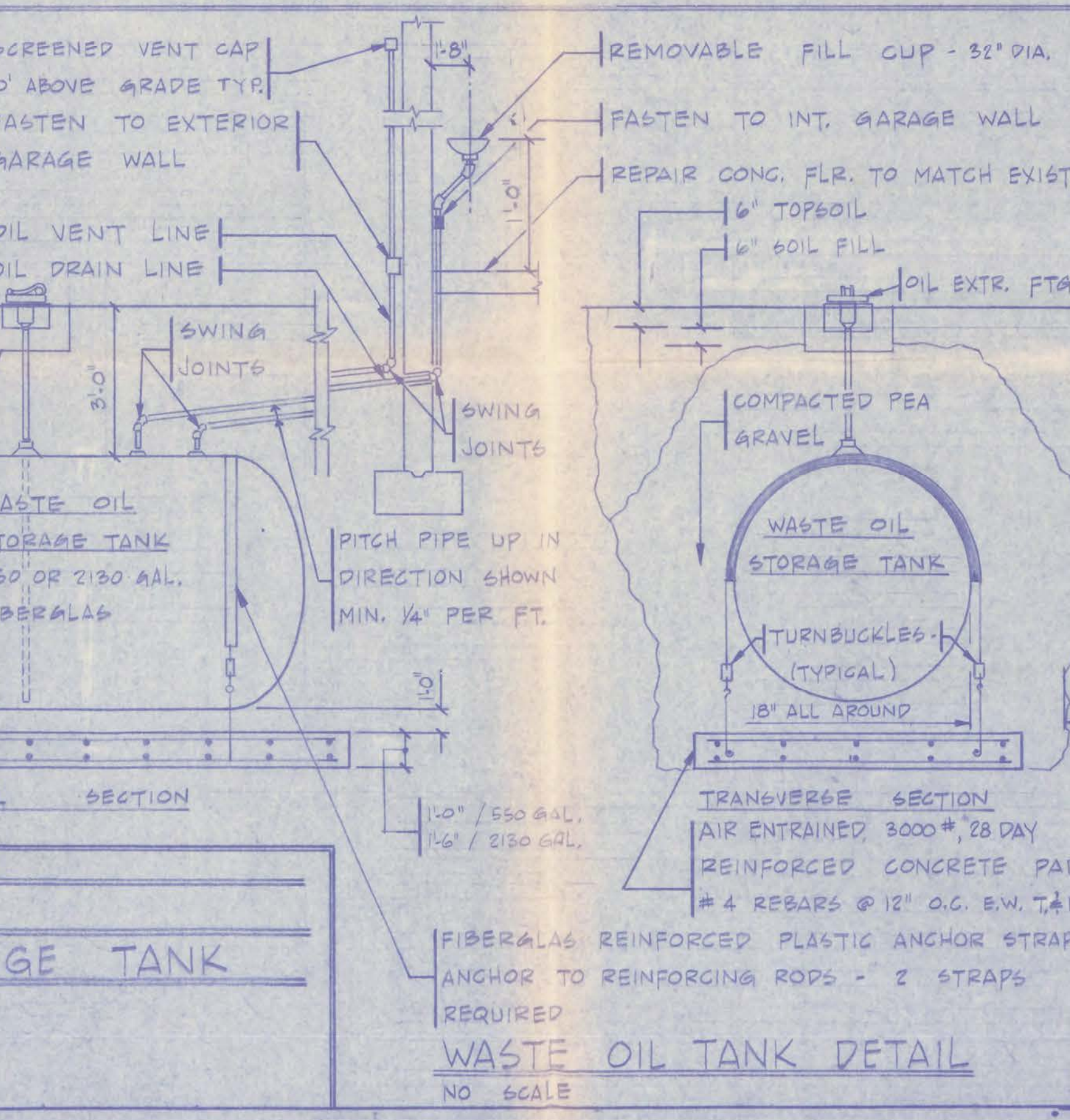
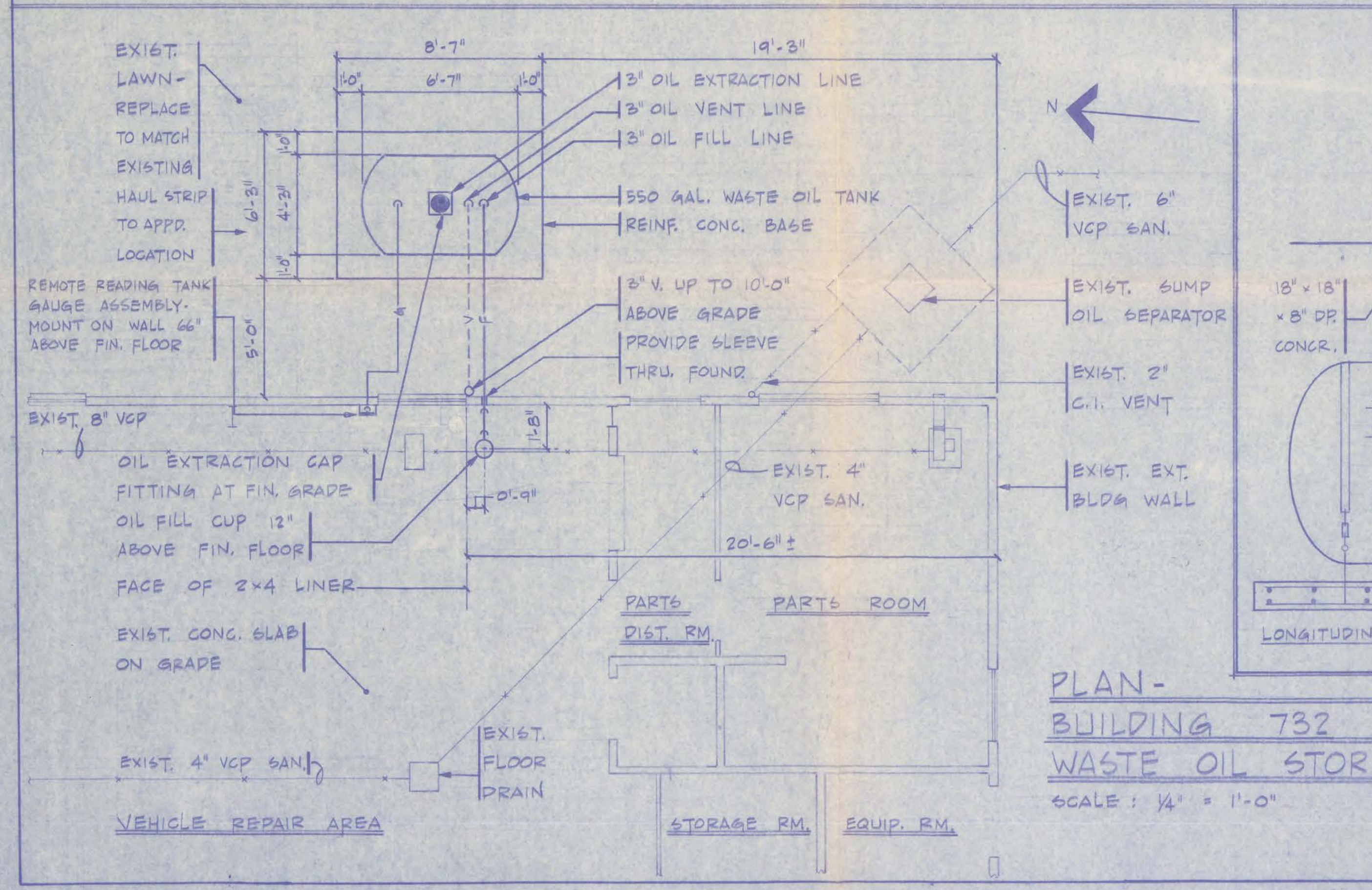

GENERAL NOTES

1. THE CONTRACTOR SHALL BE RESPONSIBLE TO IDENTIFY ALL EMPLOYEES, SUBCONTRACTORS, AND/OR SUPPLIERS WHO REQUIRE DEPOT ACCESS TO THE INTELLIGENCE OFFICE, SENECA ARMY DEPOT, AT LEAST 72 HOURS PRIOR TO THEIR INTENDED ARRIVAL ON POST.

2. THE CONTRACTOR SHALL BE RESPONSIBLE FOR BECOMING FAMILIAR WITH THE APPLICABLE SECURITY REGULATIONS AND IN INFORMING HIS EMPLOYEES AND THE EMPLOYEES OF SUBCONTRACTORS. ALL SECURITY REGULATIONS SHALL BE STRICTLY ENFORCED AND VIOLATION OF THE SAME SHALL BE CAUSE FOR DEBARMENT OF THE OFFENDER FROM THE POST.

3. IT SHALL BE THE CONTRACTORS RESPONSIBILITY TO SAFEGUARD ANY ACCESS MEDIA (BADGES, ETC.) ISSUED HIM OR HIS PERSONNEL. THE LOSS, MUTILATION OR MISUSE OF ANY DEPOT ACCESS MEDIA SHALL BE BROUGHT TO THE ATTENTION OF THE PROVOST MARSHAL SEAD, IMMEDIATELY.

4. THE CONTRACTOR SHALL BE RESPONSIBLE FOR THE SECURITY OF ANY EQUIPMENT, VEHICLES, SUPPLIES, AND/OR MATERIALS LEFT ON THE JOB SITE.

5. THE OPERATION OF ANY MOBILE/PORTABLE RADIO COMMUNICATIONS EQUIPMENT, INCLUDING CITIZEN BAND (CB) RADIOS IS PROHIBITED UNTIL THE CONTRACTOR HAS COORDINATED WITH THE COMMUNICATIONS, ELECTRONICS OFFICER (C-EO) (TEL. EXT. 18-436). THE ELECTROMAGNETIC RADIATION HAZARD (EMRH) CONTROL OFFICER (TEL. EXT. 18-277) AND AND THE PROVOST MARSHAL'S OFFICE (TEL. EXT. 18-265) AND RECEIVE APPROVAL TO OPERATE THE EQUIPMENT ON POST.

6. NO EXCAVATION OF MORE THAN 1 FOOT DEPTH SHALL BE UNDERTAKEN WITHOUT FIRST NOTIFYING THE CHIEF, MAINTENANCE DIVISION, USAAC - SENECA, (TEL. EXT. 7-299) AND ELECTRICIAN FOREMAN (TEL. EXT. 7-456) AND THE PLUMBING FOREMAN, (TEL. EXT. 7-470) FOR THE LOCATIONS AND IDENTIFICATION, AS NECESSARY, OF BURIED POWER, COMMUNICATIONS CABLES, WATER, STEAM AND SEWER LINES AT/OR IN THE VICINITY OF THE EXCAVATION OR JOB SITE.

7. THE CONTRACTOR IS RESPONSIBLE FOR PROVIDING ALL NECESSARY OCCUPATIONAL SAFETY EQUIPMENT FOR HIS AND THE SUBCONTRACTOR'S EMPLOYEES.

8. THE CONTRACTOR IS RESPONSIBLE FOR CONDUCTING ALL OPERATIONS IN ACCORDANCE WITH APPLICABLE FEDERAL, STATE AND LOCAL REGULATIONS. QUESTIONS CAN BE REFERRED TO THE SAFETY OFFICE, (TEL. EXT. 7-261 / 7-432).

9. ALL HAZARDOUS WORK, E.G. CUTTING AND WELDING, USE OF POWER ACTUATED TOOLS, REQUIRES A HAZARDOUS WORK / FLAME PERMIT ISSUED BY THE SAFETY OFFICE, (TEL. EXT. 7-261 / 7-432).

10. ALL OF THE CONTRACTOR'S EQUIPMENT SHALL BE EQUIPPED WITH AN APPROVED FIRE EXTING.

11. THE CONTRACTOR SHALL HAVE APPROVED TYPE SAFETY CANS, AND ONLY THESE SHALL BE USED FOR REFUELING OR STORAGE OF SMALL QUANTITIES OF FUEL.

12. ANY CONNECTIONS RESULTING IN SHUTDOWN OF THE FOLLOWING UTILITY SYSTEMS MUST BE SCHEDULED IN ADVANCE. (ELECTRICAL, WATER, SEWAGE, AND MAIN STEAM DISTRIBUTION SYSTEMS)

13. THE CONTRACTOR SHALL BE RESPONSIBLE FOR SAFEGUARDING & MAINTAINING SAFEGUARDS ON EXCAVATION.

14. PLUMBING WORK NOT COVERED UNDER PROJECT SPECIFICATIONS SHALL CONFORM TO AMERICAN SOCIETY OF MECHANICAL ENGINEERS (ASME) NATIONAL PLUMBING CODE. A40. (CURRENT).

15. ANY ELECTRICAL WORK NOT COVERED UNDER PROJECT SPECIFICATIONS SHALL CONFORM TO NATIONAL FIRE PROTECTION ASSOCIATION (NFPA) NATIONAL ELECTRICAL CODE. (CURRENT).

16. PRIOR TO EXCAVATION ACROSS ANY DEPOT ROADS THE CONTRACTOR SHALL ARRANGE FOR AND PROVIDE THE FOLLOWING: 1. NECESSARY DETOURS (COMPLETE WITH TEMPORARY ROADWAYS, PAVEMENTS, ETC.) 2. BARRICADES, FENCES AND TEMPORARY GUARD RAILS. 3. SIGNS, LIGHTS AND/OR OTHER NECESSARY SAFETY AIDS REQUIRED FOR SAFE TRAFFIC MOVEMENT. ALL SUCH DETOURS SHALL BE INSPECTED BY THE DEPOT SAFETY DEPARTMENT BEFORE USE OF DETOUR CAN BE ALLOWED FOR DEPOT TRAFFIC.

17. IT SHALL BE THE RESPONSIBILITY OF THE CONTRACTOR TO SURVEY & OTHERWISE POLICE ALL ROADS USED BY HIM WHEN DISPOSING OLD ROOFING, DEBRIS, NAILS, ETC. FROM THE WORK SITE TO DISPOSAL AREA.

18. THE CONTRACTOR SHALL NOT BE PERMITTED TO PLACE ANY CONCRETE, UNTIL THE CONTRACTING OFFICER'S REPRESENTATIVE HAS MADE A COMPLETE INSPECTION OF ALL WORK CONCERNING THE PREPARATION OF FORMS. A 24 HOUR NOTICE OF INTENT TO PLACE CONCRETE IS REQUIRED.

19. THIS DRAWING INDICATES THE EXTENT AND THE GENERAL LAYOUT OF THE WORK TO BE PERFORMED. ALL DIMENSIONS AND DATA SHOWN ON THE DRAWING SHALL BE VERIFIED IN THE FIELD BY THE CONTRACTOR.

APPROVED BY	APPROVED BY
CHIEF OF ROADS & GROUNDS	CHIEF OF UTILITIES
APPROVED BY	APPROVED BY
	CHIEF/PROTECTIVE SERVS. DIV.
APPROVED BY	APPROVED BY
Thomas P. ... CHIEF OF FIRE PROTECTION BR.	Danny M. ... SAFETY MANAGER
MACKNIGHT - FULIGNI - FRAGOLA	
ARCHITECTS	
ROBSON & WOESE	
CONSULTING ENGINEERS	
OFFICE OF THE FACILITIES ENGINEER SENECA ARMY DEPOT ROMULUS, NEW YORK 14541	
SCALE	PROJECT
REVISIONS	WASTE OIL TANKS 117, 355 & 732
SYM DATE BY	SHEET TITLE
	DETAILS
APPROVED	CONCURRENCE
Jacob P. ...	
DATE	FACILITIES ENGINEER
9 JULY 81	CONCURRENCE
	SHEET NO. 1 OF 132-8